

INDUCTIVE

INDUCTIVE SENSORS

Ultra Mini



p-u-l-s-o-t-r-o-n-i-c

p-u-l-s-o-t-r-o-n-i-c

About us

In the traditional and strive industry region Chemnitz-Zwickau, directly at the freeway A72 you will find the new location of the Pulsotronic GmbH & Co.KG.

As a worldwide active company we develop and produce according to ISO 9001 proximity switches and electronic components for the following product ranges:

- > Inductive and Capacitive Sensors
- > Metal separation and Metal detection
- > Picture Processing
- > Optical Sensors
- > Magnetoresistive Sensors
- > Laser Systems
- > Colour Detection
- > Ultrasonic Sensors
- > X-Ray- Scanner

We guarantee customized solutions by our high-performance profile in the area. The available wide palette of key technologies is an ideal condition for the realization of your application.

You find the Pulsotronic everywhere there, where are to set standards and to solve task positions on the far side of well known standing types.

With innovation and individualism our competent team will advise also on place to solve your problem.

Demand us, than you will also find out:

„Pulsotronic - Here is the solution.“

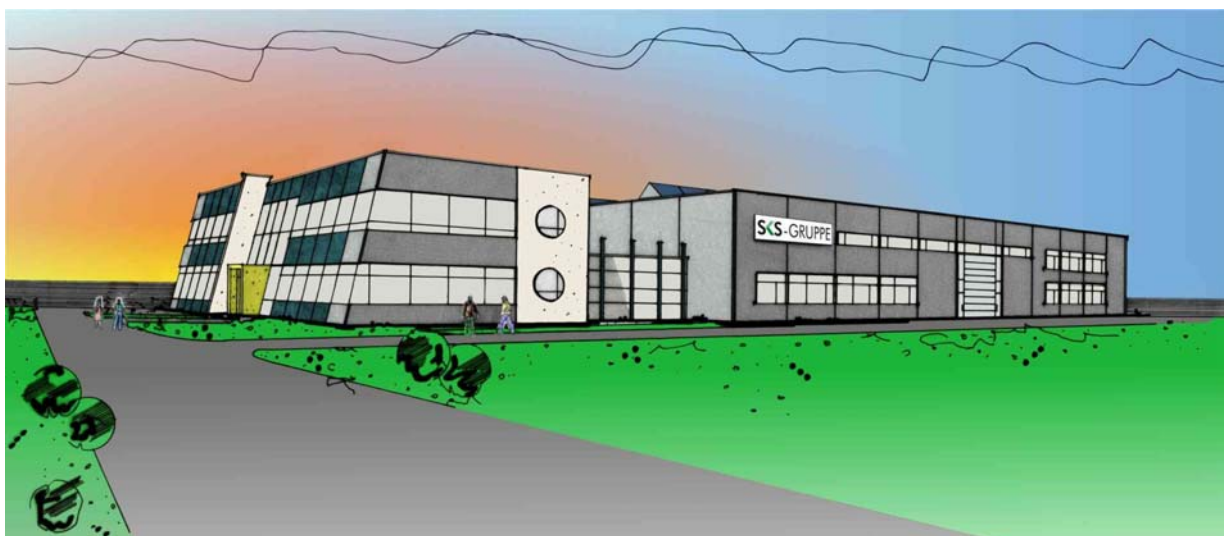

K J 10 - M 30 M B 45 - D P S - V1 - X000
T T T T T T T T T T T T
1 2 3 4 5 6 7 8 9 10 11 12

1= Working principle:	J	inductive	JR	inductive ring
			JF	inductive surface
			JG	inductive slot
			JD	full metal
	C	capacitive		
	M	magneto-resistive		
2= Switching distance / range				
3= Design:	M	cylindrical housings with metrical thread		
	G	cylindrical housings without thread		
	Q	square housings		
	D	ring housings		
4= Housing diameter / edge length				
5= Housing material:	M	brass, nickel plated	11= Kind of Connection:	V1 M8 screw / snap in
	E	stainless steel 1.4305		V2 M12 metal
	K	plastic		V2/1 M12 plastic
	A	aluminium		V3 M5 metal
6= installation type:	B	shielded		V4 Amphenol Tuchel
	N	non shielded		V6 Brad Harrison
7= Tube length:		for cylindrical devices in mm		V7 valve connector type A
8= Operating voltage:	D	DC direct-current voltage		V8 M8 only snap in
	AZ	AC alternating-current voltage		V9 M12 only snap in
	VZ	AC/DC all voltages		V10 valve connector type C
				V11 AC-connector 1/2" UNF
				V12 M18 plastic
				VE Euchner connector
				ZW termination box 90°
				RS232 data interface
				PG thread joint PG
				Mxx thread joint metrical
9= Type of the output signal:	P	PNP		more at inquiry
	N	NPN		
	Z	two-wire		
	AN	analog	ANI	current output
			ANU	voltage output
	NA	Namur		
10= Function:	S	N.O.		
	Ö	N.C.		
	A	changeover		
	U	switchable		
	I	impulse output		
	D	data interface		
12= Addition mark:	SF	weld field immune		
	T	high temperature		
	FE	reduction 1 to steel/iron		
	NF	reduction 1 to aluminium		
	X	customized design		
	W	angled sensing face / angled cable exit		
	AM	middle sensing face		

Proximity switch - Connection pictures

wiring diagrams	cable- / clampconnection	connector V1 ... V9
DPS DC PNP N.O.		
DPÖ DC PNP N.C.		
DPA DC PNP changeover		
DPU DC NO/NC switchable		
DNS DC NPN N.O.		
DNÖ DC NPN N.C.		
DNA DC NPN changeover		
DNU DC NO/NC switchable		
NA Namur DIN 19234		
DZS DC 2-wire N.O.		
DZÖ DC 2-wire N.C.		
AZS / VZS AC/DC 2-wire N.O.		
AZÖ / VZÖ AC/DC 2-wire N.C.		
Analog		

p-u-l-s-o-t-r-o-n-i-c

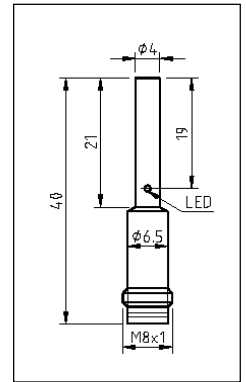
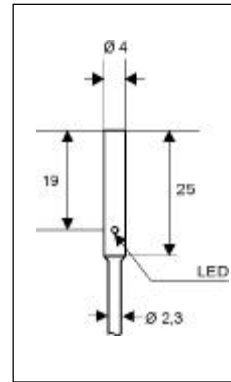
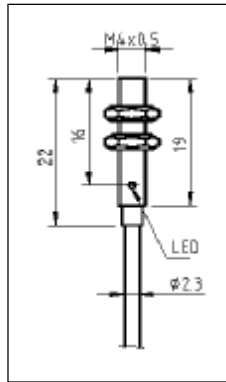
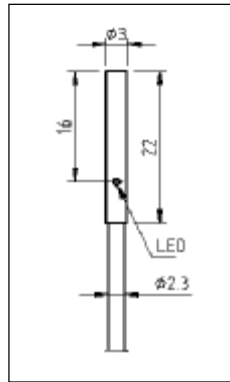

Switching Distance	0,8 mm	0,8 mm	1 mm	1 mm
Mounting	Shielded	Shielded	Shielded	Shielded
Type				
PNP Normally Open	SJ0,8-G3EB22-DPS	SJ0,8-M4EB22-DPS	SJ1-G4EB25-DPS	SJ1-G4EB40-DPS-V1
PNP Normally Close	SJ0,8-G3EB22-DPÖ	SJ0,8-M4EB22-DPÖ	SJ1-G4EB25-DPÖ	SJ1-G4EB40-DPÖ-V1
NPN Normally Open	SJ0,8-G3EB22-DNS	SJ0,8-M4EB22-DNS	SJ1-G4EB25-DNS	SJ1-G4EB40-DNS-V1
NPN Normally Close	SJ0,8-G3EB22-DNÖ	SJ0,8-M4EB22-DNÖ	SJ1-G4EB25-DNÖ	SJ1-G4EB40-DNÖ-V1
PNP Changeover				
NPN Changeover				
Operating Voltage U_b	10 - 30 VDC	10 - 30 VDC	10 - 30 VDC	10 - 30 VDC
Ripple Voltage	£ 10 %	£ 10 %	£ 10 %	10 %
Voltage Drop U_d	£ 1,0 V	£ 1,0 V	£ 1,0 V	1,0 V
Max. Load Current I_o	200 mA	200 mA	200 mA	200 mA
Off-State Current I_o	£ 10 mA	£ 10 mA	£ 10 mA	10 mA
Leakage Current I_r	£ 10 µA	£ 10 µA	£ 10 µA	10 µA
Switching Frequency f	2000 Hz	2000 Hz	2000 Hz	2000 Hz
Hysteresis H	£ 15 %	£ 15 %	£ 15 %	£ 15 %
Operating Temperature T_a	-25°C ... +70°C	-25°C ... +70°C	-25°C ... +70°C	-25°C ... +70°C
Temperature Drift	£ 10 %	£ 10 %	£ 10 %	£ 10 %
Repeat Accuracy R	£ 1,0 %	£ 1,0 %	£ 1,0 %	£ 1,0 %
Protection Class	IP 67	IP 67	IP 67	IP 67
Switching State	LED yellow	LED yellow	LED yellow	LED yellow
EMC-Standard	EN 60947-5-2	EN 60947-5-2	EN 60947-5-2	EN 60947-5-2
Housing Material	Stainless Steel	Stainless Steel	Stainless Steel	Stainless Steel
Front Cap	POM	POM	POM	POM
Termination	Cable PVC 3x0.15	Cable PVC 3x0.15	Cable PVC 3x0.15	M8 3pol. Connector

More special versions by separate inquiries!

Connection and Termination picture at page 3.

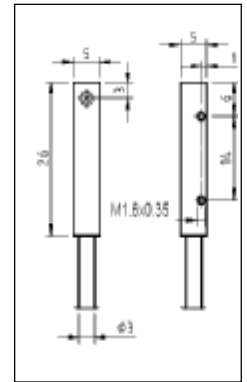
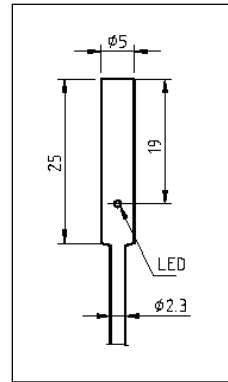
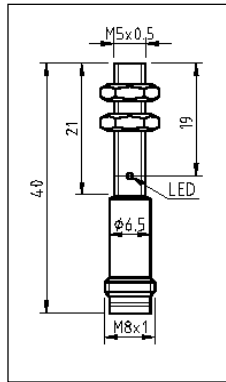
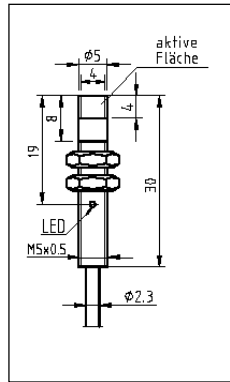

Switching Distance	1 mm	1 mm	1,5 mm	1 mm
Mounting	Shielded	Shielded	Shielded	Shielded
Type				
PNP Normally Open	SJ1W-M5EB30-DPS	SJ1-M5EB40-DPS-V1	SJ1,5-G5EB25-DPS	SJ1-Q5MB26-DPS
PNP Normally Close	SJ1W-M5EB30-DPÖ	SJ1-M5EB40-DPÖ-V1	SJ1,5-G5EB25-DPÖ	SJ1-Q5MB26-DPÖ
NPN Normally Open	SJ1W-M5EB30-DNS	SJ1-M5EB40-DNS-V1	SJ1,5-G5EB25-DNS	SJ1-Q5MB26-DNS
NPN Normally Close	SJ1W-M5EB30-DNÖ	SJ1-M5EB40-DNÖ-V1	SJ1,5-G5EB25-DNÖ	SJ1-Q5MB26-DNÖ
PNP Changeover				
NPN Changeover				
Operating Voltage U_b	10 - 30 VDC	10 - 30 VDC	10 - 30 VDC	10 - 30 VDC
Ripple Voltage	£ 10 %	£ 10 %	£ 10 %	10 %
Voltage Drop U_d	£ 1,0 V	£ 1,0 V	£ 1,0 V	1,0 V
Max. Load Current I_o	200 mA	200 mA	200 mA	200 mA
Off-State Current I_o	£ 10 mA	£ 10 mA	£ 10 mA	10 mA
Leakage Current I_r	£ 10 µA	£ 10 µA	£ 10 µA	10 µA
Switching Frequency f	2000 Hz	2000 Hz	2000 Hz	2000 Hz
Hysteresis H	£ 15 %	£ 15 %	£ 15 %	£ 15 %
Operating Temperature T_a	-25°C ... +70°C	-25°C ... +70°C	-25°C ... +70°C	-25°C ... +70°C
Temperature Drift	£ 10 %	£ 10 %	£ 10 %	£ 10 %
Repeat Accuracy R	£ 1,0 %	£ 1,0 %	£ 1,0 %	£ 1,0 %
Protection Class	IP 67	IP 67	IP 67	IP 67
Switching State	LED yellow	LED yellow	LED yellow	LED yellow
EMC-Standard	EN 60947-5-2	EN 60947-5-2	EN 60947-5-2	EN 60947-5-2
Housing Material	Stainless Steel	Stainless Steel	Stainless Steel	Brass Nickel-Plated
Front Cap	POM	POM	POM	POM
Termination	CablePVC 3x0.15	M8 3pol. Connector	Cable PVC 3x0.15	Cable PVC 3x0.15

More special versions by separate inquiries!

Connection and Termination picture at page 3.

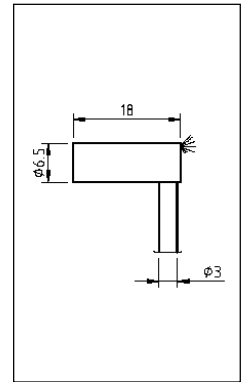
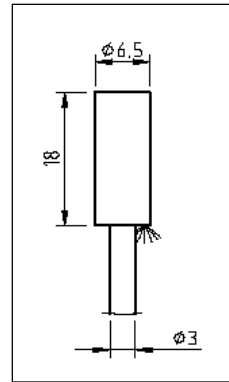
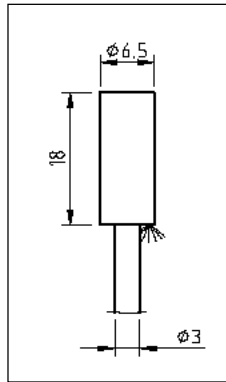
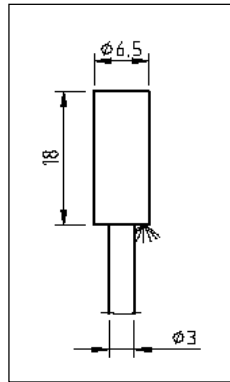

Switching Distance	1,5 mm	2 mm	3 mm	1,5 mm
Mounting	Shielded	Shielded	Shielded	Shielded
Type				
PNP Normally Open	SJ1,5-G6,5EB18-DPS	SJ2-G6,5EB18-DPS	SJ3-G6,5EB18-DPS	SJ1,5-G6,5EB18-DPS-W
PNP Normally Close	SJ1,5-G6,5EB18-DPÖ	SJ2-G6,5EB18-DPÖ	SJ3-G6,5EB18-DPÖ	SJ1,5-G6,5EB18-DPÖ-W
NPN Normally Open	SJ1,5-G6,5EB18-DNS	SJ2-G6,5EB18-DNS	SJ3-G6,5EB18-DNS	SJ1,5-G6,5EB18-DNS-W
NPN Normally Close	SJ1,5-G6,5EB18-DNÖ	SJ2-G6,5EB18-DNÖ	SJ3-G6,5EB18-DNÖ	SJ1,5-G6,5EB18-DNÖ-W
PNP Changeover				
NPN Changeover				
Operating Voltage U_b	10 - 30 VDC	10 - 30 VDC	10 - 30 VDC	10 - 30 VDC
Ripple Voltage	£ 10 %	£ 10 %	£ 10 %	10 %
Voltage Drop U_d	£ 1,0 V	£ 1,0 V	£ 1,0 V	1,0 V
Max. Load Current I_o	200 mA	200 mA	200 mA	200 mA
Off-State Current I_o	£ 10 mA	£ 10 mA	£ 10 mA	10 mA
Leakage Current I_r	£ 10 µA	£ 10 µA	£ 10 µA	10 µA
Switching Frequency f	2000 Hz	2000 Hz	2000 Hz	2000 Hz
Hysteresis H	£ 15 %	£ 15 %	£ 15 %	£ 15 %
Operating Temperature T_a	-25°C ... +70°C	-25°C ... +70°C	-25°C ... +70°C	-25°C ... +70°C
Temperature Drift	£ 10 %	£ 10 %	£ 10 %	£ 10 %
Repeat Accuracy R	£ 1,0 %	£ 1,0 %	£ 1,0 %	£ 1,0 %
Protection Class	IP 67	IP 67	IP 67	IP 67
Switching State	LED yellow	LED yellow	LED yellow	LED yellow
EMC-Standard	EN 60947-5-2	EN 60947-5-2	EN 60947-5-2	EN 60947-5-2
Housing Material	Stainless Steel	Stainless Steel	Stainless Steel	Stainless Steel
Front Cap	POM	POM	POM	POM
Termination	Cable PVC 3x0.15	Cable PVC 3x0.15	Cable PVC 3x0.15	Cable PVC 3x0.15

More special versions by separate inquiries!

Connection and Termination picture at page 3.

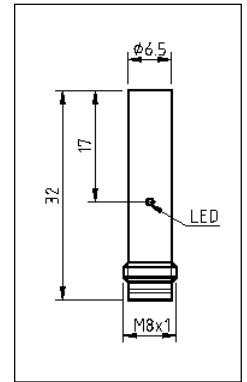
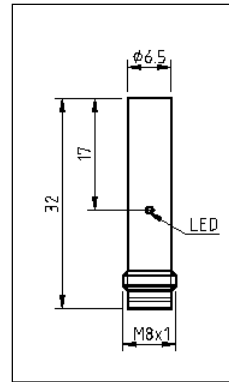
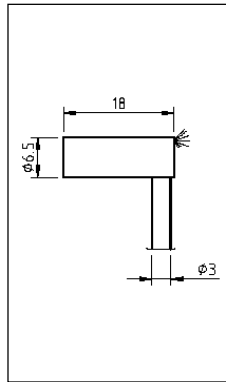
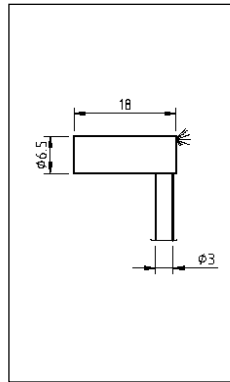

Switching Distance	2 mm	3 mm	1,5 mm	2 mm
Mounting	Shielded	Shielded	Shielded	Shielded
Type				
PNP Normally Open	SJ2-G6,5EB18-DPS-W	SJ3-G6,5EB18-DPS-W	SJ1,5-G6,5EB32-DPS-V1	SJ2-G6,5EB32-DPS-V1
PNP Normally Close	SJ2-G6,5EB18-DPÖ-W	SJ3-G6,5EB18-DPÖ-W	SJ1,5-G6,5EB32-DPÖ-V1	SJ2-G6,5EB32-DPÖ-V1
NPN Normally Open	SJ2-G6,5EB18-DNS-W	SJ3-G6,5EB18-DNS-W	SJ1,5-G6,5EB32-DNS-V1	SJ2-G6,5EB32-DNS-V1
NPN Normally Close	SJ2-G6,5EB18-DNÖ-W	SJ3-G6,5EB18-DNÖ-W	SJ1,5-G6,5EB32-DNÖ-V1	SJ2-G6,5EB32-DNÖ-V1
PNP Changeover				
NPN Changeover				
Operating Voltage U_b	10 - 30 VDC	10 - 30 VDC	10 - 30 VDC	10 - 30 VDC
Ripple Voltage	£ 10 %	£ 10 %	£ 10 %	10 %
Voltage Drop U_d	£ 1,0 V	£ 1,0 V	£ 1,0 V	1,0 V
Max. Load Current I_o	200 mA	200 mA	200 mA	200 mA
Off-State Current I_o	£ 10 mA	£ 10 mA	£ 10 mA	10 mA
Leakage Current I_r	£ 10 µA	£ 10 µA	£ 10 µA	10 µA
Switching Frequency f	2000 Hz	2000 Hz	2000 Hz	2000 Hz
Hysteresis H	£ 15 %	£ 15 %	£ 15 %	£ 15 %
Operating Temperature T_a	-25°C ... +70°C	-25°C ... +70°C	-25°C ... +70°C	-25°C ... +70°C
Temperature Drift	£ 10 %	£ 10 %	£ 10 %	£ 10 %
Repeat Accuracy R	£ 1,0 %	£ 1,0 %	£ 1,0 %	£ 1,0 %
Protection Class	IP 67	IP 67	IP 67	IP 67
Switching State	LED yellow	LED yellow	LED yellow	LED yellow
EMC-Standard	EN 60947-5-2	EN 60947-5-2	EN 60947-5-2	EN 60947-5-2
Housing Material	Stainless Steel	Stainless Steel	Stainless Steel	Stainless Steel
Front Cap	POM	POM	POM	POM
Termination	Cable PVC 3x0.15	Cable PVC 3x0.15	M8 Connector	M8 Connector

More special versions by separate inquiries!

Connection and Termination picture at page 3.

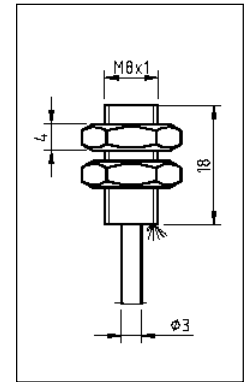
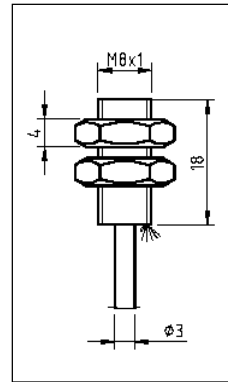
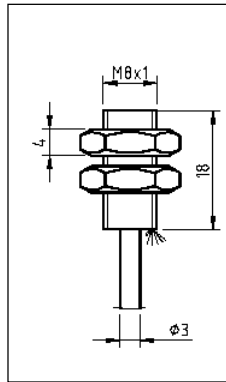
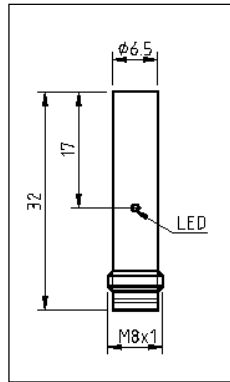

Switching Distance	3 mm	1,5 mm	2 mm	3 mm
Mounting	Shielded	Shielded	Shielded	Shielded
	Type	Type	Type	Type
PNP Normally Open	SJ3-G6,5EB32-DPS-V1	SJ1,5-M8EB18-DPS	SJ2-M8EB18-DPS	SJ3-M8EB18-DPS
PNP Normally Close	SJ3-G6,5EB32-DPÖ-V1	SJ1,5-M8EB18-DPÖ	SJ2-M8EB18-DPÖ	SJ3-M8EB18-DPÖ
NPN Normally Open	SJ3-G6,5EB32-DNS-V1	SJ1,5-M8EB18-DNS	SJ2-M8EB18-DNS	SJ3-M8EB18-DNS
NPN Normally Close	SJ3-G6,5EB32-DNÖ-V1	SJ1,5-M8EB18-DNÖ	SJ2-M8EB18-DNÖ	SJ3-M8EB18-DNÖ
PNP Changeover				
NPN Changeover				
Operating Voltage U_b	10 - 30 VDC	10 - 30 VDC	10 - 30 VDC	10 - 30 VDC
Ripple Voltage	£ 10 %	£ 10 %	£ 10 %	10 %
Voltage Drop U_d	£ 1,0 V	£ 1,0 V	£ 1,0 V	1,0 V
Max. Load Current I_o	200 mA	200 mA	200 mA	200 mA
Off-State Current I_o	£ 10 mA	£ 10 mA	£ 10 mA	10 mA
Leakage Current I_r	£ 10 µA	£ 10 µA	£ 10 µA	10 µA
Switching Frequency f	2000 Hz	2000 Hz	2000 Hz	2000 Hz
Hysteresis H	£ 15 %	£ 15 %	£ 15 %	£ 15 %
Operating Temperature T_a	-25°C ... +70°C	-25°C ... +70°C	-25°C ... +70°C	-25°C ... +70°C
Temperature Drift	£ 10 %	£ 10 %	£ 10 %	£ 10 %
Repeat Accuracy R	£ 1,0 %	£ 1,0 %	£ 1,0 %	£ 1,0 %
Protection Class	IP 67	IP 67	IP 67	IP 67
Switching State	LED yellow	LED yellow	LED yellow	LED yellow
EMC-Standard	EN 60947-5-2	EN 60947-5-2	EN 60947-5-2	EN 60947-5-2
Housing Material	Stainless Steel	Stainless Steel	Stainless Steel	Stainless Steel
Front Cap	POM	POM	POM	POM
Termination	M8 3pol. Connector	Cable PVC 3x0.15	Cable PVC 3x0.15	CablePVC 3x0.15

More special versions by separate inquiries!

Connection and Termination picture at page 3.

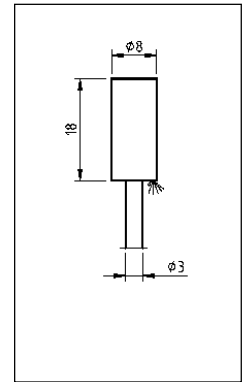
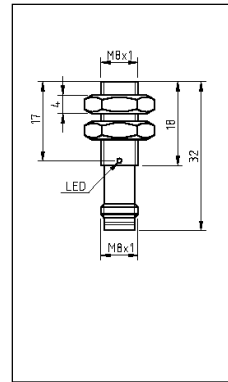
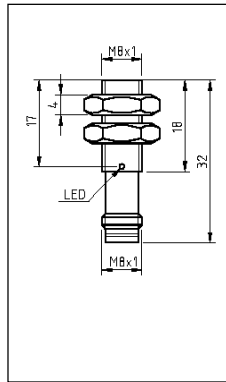
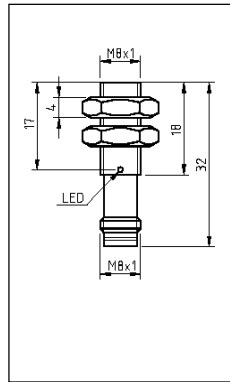

Switching Distance	1,5 mm	2 mm	3 mm	1,5 mm
Mounting	Shielded	Shielded	Shielded	Shielded
	Type	Type	Type	Type
PNP Normally Open	SJ1,5-M8EB32-DPS-V1	SJ2-M8EB32-DPS-V1	SJ3-M8EB32-DPS-V1	SJ1,5-G8EB18-DPS
PNP Normally Close	SJ1,5-M8EB32-DPÖ-V1	SJ2-M8EB32-DPÖ-V1	SJ3-M8EB32-DPÖ-V1	SJ1,5-G8EB18-DPÖ
NPN Normally Open	SJ1,5-M8EB32-DNS-V1	SJ2-M8EB32-DNS-V1	SJ3-M8EB32-DNS-V1	SJ1,5-G8EB18-DNS
NPN Normally Close	SJ1,5-M8EB32-DNÖ-V1	SJ2-M8EB32-DNÖ-V1	SJ3-M8EB32-DNÖ-V1	SJ1,5-G8EB18-DNÖ
PNP Changeover				
NPN Changeover				
Operating Voltage U_b	10 - 30 VDC	10 - 30 VDC	10 - 30 VDC	10 - 30 VDC
Ripple Voltage	£ 10 %	£ 10 %	£ 10 %	10 %
Voltage Drop U_d	£ 1,0 V	£ 1,0 V	£ 1,0 V	1,0 V
Max. Load Current I_o	200 mA	200 mA	200 mA	200 mA
Off-State Current I_o	£ 10 mA	£ 10 mA	£ 10 mA	10 mA
Leakage Current I_r	£ 10 µA	£ 10 µA	£ 10 µA	10 µA
Switching Frequency f	2000 Hz	2000 Hz	2000 Hz	2000 Hz
Hysteresis H	£ 15 %	£ 15 %	£ 15 %	£ 15 %
Operating Temperature T_a	-25°C ... +70°C	-25°C ... +70°C	-25°C ... +70°C	-25°C ... +70°C
Temperature Drift	£ 10 %	£ 10 %	£ 10 %	£ 10 %
Repeat Accuracy R	£ 1,0 %	£ 1,0 %	£ 1,0 %	£ 1,0 %
Protection Class	IP 67	IP 67	IP 67	IP 67
Switching State	LED yellow	LED yellow	LED yellow	LED yellow
EMC-Standard	EN 60947-5-2	EN 60947-5-2	EN 60947-5-2	EN 60947-5-2
Housing Material	Stainless Steel	Stainless Steel	Stainless Steel	Stainless Steel
Front Cap	POM	POM	POM	POM
Termination	M8 3pol. Connector	M8 3pol. Connector	M8 3pol. Connector	CablePVC 3x0.15

More special versions by separate inquiries!

Connection and Termination picture at page 3.

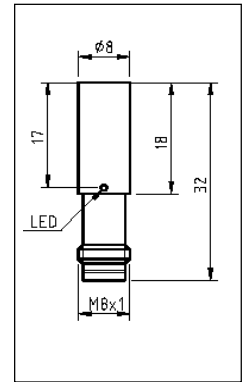
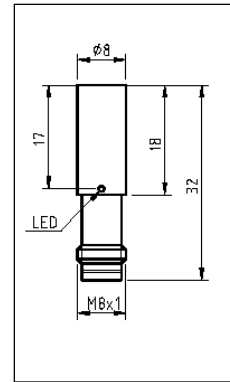
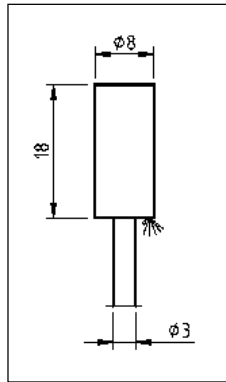
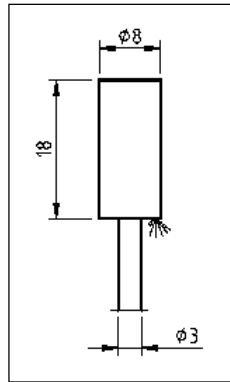

Switching Distance	2 mm	3 mm	1,5 mm	2 mm
Mounting	Shielded	Shielded	Shielded	Shielded
Type				
PNP Normally Open	SJ2-G8EB18-DPS	SJ3-G8EB18-DPS	SJ1,5-G8EB32-DPS-V1	SJ2-G8EB32-DPS-V1
PNP Normally Close	SJ2-G8EB18-DPÖ	SJ3-G8EB18-DPÖ	SJ1,5-G8EB32-DPÖ-V1	SJ2-G8EB32-DPÖ-V1
NPN Normally Open	SJ2-G8EB18-DNS	SJ3-G8EB18-DNS	SJ1,5-G8EB32-DNS-V1	SJ2-G8EB32-DNS-V1
NPN Normally Close	SJ2-G8EB18-DNÖ	SJ3-G8EB18-DNÖ	SJ1,5-G8EB32-DNÖ-V1	SJ2-G8EB32-DNÖ-V1
PNP Changeover				
NPN Changeover				
Operating Voltage U_b	10 - 30 VDC	10 - 30 VDC	10 - 30 VDC	10 - 30 VDC
Ripple Voltage	£ 10 %	£ 10 %	£ 10 %	10 %
Voltage Drop U_d	£ 1,0 V	£ 1,0 V	£ 1,0 V	1,0 V
Max. Load Current I_o	200 mA	200 mA	200 mA	200 mA
Off-State Current I_o	£ 10 mA	£ 10 mA	£ 10 mA	10 mA
Leakage Current I_r	£ 10 µA	£ 10 µA	£ 10 µA	10 µA
Switching Frequency f	2000 Hz	2000 Hz	2000 Hz	2000 Hz
Hysteresis H	£ 15 %	£ 15 %	£ 15 %	£ 15 %
Operating Temperature T_a	-25°C ... +70°C	-25°C ... +70°C	-25°C ... +70°C	-25°C ... +70°C
Temperature Drift	£ 10 %	£ 10 %	£ 10 %	£ 10 %
Repeat Accuracy R	£ 1,0 %	£ 1,0 %	£ 1,0 %	£ 1,0 %
Protection Class	IP 67	IP 67	IP 67	IP 67
Switching State	LED yellow	LED yellow	LED yellow	LED yellow
EMC-Standard	EN 60947-5-2	EN 60947-5-2	EN 60947-5-2	EN 60947-5-2
Housing Material	Stainless Steel	Stainless Steel	Stainless Steel	Stainless Steel
Front Cap	POM	POM	POM	POM
Termination	Cable PVC 3x0.15	Cable PVC 3x0.15	M8 3pol. Connector	M8 3pol. Connector

More special versions by separate inquiries!

Connection and Termination picture at page 3.

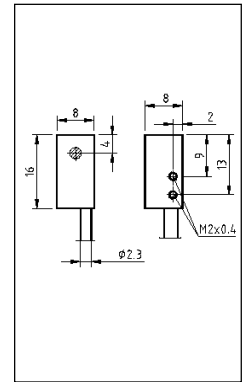
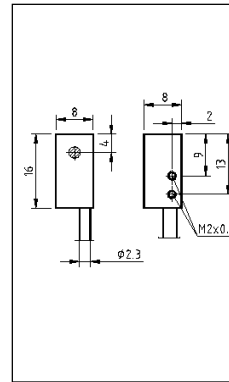
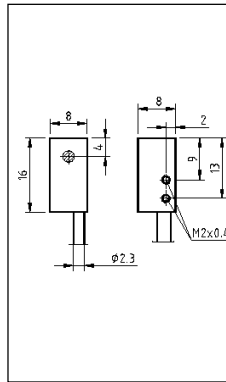
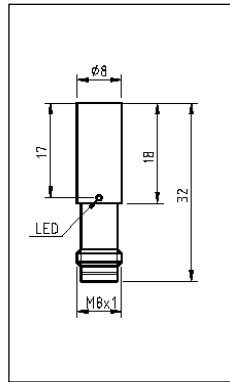

Switching Distance	3 mm	1,5 mm	2 mm	3 mm
Mounting	Shielded	Shielded	Shielded	Shielded
	Type	Type	Type	Type
PNP Normally Open	SJ3-G8EB32-DPS-V1	SJ1,5-Q8MB16-DPS	SJ2-Q8MB16-DPS	SJ3-Q8MB16-DPS
PNP Normally Close	SJ3-G8EB32-DPÖ-V1	SJ1,5-Q8MB16-DPÖ	SJ2-Q8MB16-DPÖ	SJ3-Q8MB16-DPÖ
NPN Normally Open	SJ3-G8EB32-DNS-V1	SJ1,5-Q8MB16-DNS	SJ2-Q8MB16-DNS	SJ3-Q8MB16-DNS
NPN Normally Close	SJ3-G8EB32-DNÖ-V1	SJ1,5-Q8MB16-DNÖ	SJ2-Q8MB16-DNÖ	SJ3-Q8MB16-DNÖ
PNP Changeover				
NPN Changeover				
Operating Voltage U_b	10 - 30 VDC	10 - 30 VDC	10 - 30 VDC	10 - 30 VDC
Ripple Voltage	£ 10 %	£ 10 %	£ 10 %	10 %
Voltage Drop U_d	£ 1,0 V	£ 1,0 V	£ 1,0 V	1,0 V
Max. Load Current I_o	200 mA	200 mA	200 mA	200 mA
Off-State Current I_o	£ 10 mA	£ 10 mA	£ 10 mA	10 mA
Leakage Current I_r	£ 10 µA	£ 10 µA	£ 10 µA	10 µA
Switching Frequency f	2000 Hz	2000 Hz	2000 Hz	2000 Hz
Hysteresis H	£ 15 %	£ 15 %	£ 15 %	£ 15 %
Operating Temperature T_a	-25°C ... +70°C	-25°C ... +70°C	-25°C ... +70°C	-25°C ... +70°C
Temperature Drift	£ 10 %	£ 10 %	£ 10 %	£ 10 %
Repeat Accuracy R	£ 1,0 %	£ 1,0 %	£ 1,0 %	£ 1,0 %
Protection Class	IP 67	IP 67	IP 67	IP 67
Switching State	LED yellow	LED yellow	LED yellow	LED yellow
EMC-Standard	EN 60947-5-2	EN 60947-5-2	EN 60947-5-2	EN 60947-5-2
Housing Material	Stainless Steel	Brass Nickel-Plated	Brass Nickel-Plated	Brass Nickel-Plated
Front Cap	POM	POM	POM	POM
Termination	M8 3pol. Connector	Cable PVC 3x0.15	Cable PVC 3x0.15	Cable PVC 3x0.15

More special versions by separate inquiries!

Connection and Termination picture at page 3.

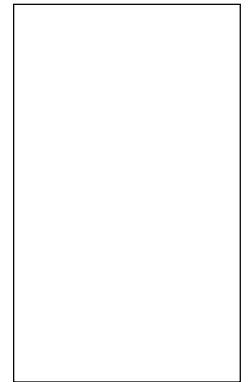
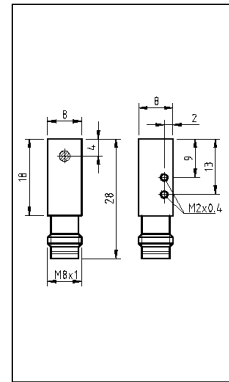
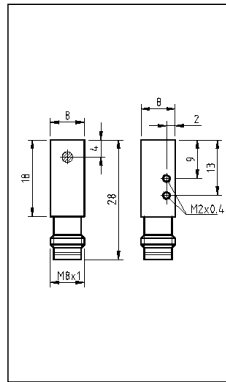
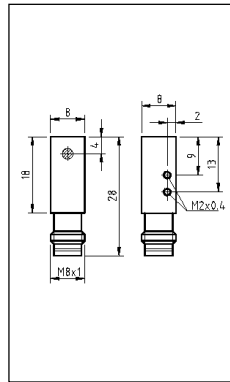

Switching Distance

1,5 mm

2 mm

3 mm

Mounting

Shielded

Shielded

Shielded

Type

Type

Type

PNP Normally Open

SJ1,5-Q8MB28-DPS-V1

SJ2-Q8MB28-DPS-V1

SJ3-Q8MB28-DPS-V1

PNP Normally Close

SJ1,5-Q8MB28-DPÖ-V1

SJ2-Q8MB28-DPÖ-V1

SJ3-Q8MB28-DPÖ-V1

NPN Normally Open

SJ1,5-Q8MB28-DNS-V1

SJ2-Q8MB28-DNS-V1

SJ3-Q8MB28-DNS-V1

NPN Normally Close

SJ1,5-Q8MB28-DNÖ-V1

SJ2-Q8MB28-DNÖ-V1

SJ3-Q8MB28-DNÖ-V1

PNP Changeover

NPN Changeover

Operating Voltage U_b

10 - 30 VDC

10 - 30 VDC

10 - 30 VDC

Ripple Voltage

£ 10 %

£ 10 %

£ 10 %

Voltage Drop U_d

£ 1,0 V

£ 1,0 V

£ 1,0 V

Max. Load Current I_o

200 mA

200 mA

200 mA

Off-State Current I_o

£ 10 mA

£ 10 mA

£ 10 mA

Leakage Current I_r

£ 10 µA

£ 10 µA

£ 10 µA

Switching Frequency f

2000 Hz

2000 Hz

2000 Hz

Hysteresis H

£ 15 %

£ 15 %

£ 15 %

Operating Temperature T_a

-25°C ... +70°C

-25°C ... +70°C

-25°C ... +70°C

Temperature Drift

£ 10 %

£ 10 %

£ 10 %

Repeat Accuracy R

£ 1,0 %

£ 1,0 %

£ 10 %

Protection Class

IP 67

IP 67

IP 67

Switching State

LED yellow

LED yellow

LED yellow

EMC-Standard

IEC 60947-5-2

IEC 60947-5-2

IEC 60947-5-2

Housing Material

Brass Nickel-Plated

Brass Nickel-Plated

Brass Nickel-Plated

Front Cap

POM

POM

POM

Termination

M8 3pol. Connector

M8 3pol. Connector

M8 3pol. Connector

More special versions by separate inquiries!

Connection and Termination picture at page 3.

Type	Art-Nr.	Site	Type	Art-Nr.	Site
G3					
SJ0,8-G3EB22-DPS	08313030081	4	SJ3-G8EB32-DPS-V1	08313680311	12
SJ0,8-G3EB22-DPÖ	08313030082	4	SJ3-G8EB32-DPÖ-V1	08313680321	12
SJ0,8-G3EB22-DNS	08313030083	4	SJ3-G8EB32-DNS-V1	08313680331	12
SJ0,8-G3EB22-DNÖ	08313030084	4	SJ3-G8EB32-DNÖ-V1	08313680341	12
G4					
SJ1-G4EB25-DPS	08313040110	4	M4		
SJ1-G4EB25-DPÖ	08313040120	4	SJ0,8-M4EB22-DPS	08313040085	4
SJ1-G4EB25-DNS	08313040130	4	SJ0,8-M4EB22-DPÖ	08313040086	4
SJ1-G4EB25-DNÖ	08313040140	4	SJ0,8-M4EB22-DNS	08313040087	4
SJ1-G4EB40-DPS-V1	08313040111	4	SJ0,8-M4EB22-DNÖ	08313040088	4
SJ1-G4EB40-DPÖ-V1	08313040121	4	M5		
SJ1-G4EB40-DNS-V1	08313040131	4	SJ1-M5EB25-DPS	08313050110	5
SJ1-G4EB40-DNÖ-V1	08313040141	4	SJ1-M5EB25-DPÖ	08313050120	5
SJ1W-G4EB30-DPS	08313040112	5	SJ1-M5EB25-DNS	08313050130	5
SJ1W-G4EB30-DPÖ	08313040122	5	SJ1-M5EB25-DNÖ	08313050140	5
SJ1W-G4EB30-DNS	08313040132	5	SJ0,8-M5EB28-DPS	08313050114	5
SJ1W-G4EB30-DNÖ	08313040142	5	SJ0,8-M5EB28-DPÖ	08313050124	5
SJ1W-G4EB40-DPS-V1	08313040113	5	SJ0,8-M5EB28-DNS	08313050134	5
SJ1W-G4EB40-DPÖ-V1	08313040123	5	SJ0,8-M5EB28-DNÖ	08313050144	5
SJ1W-G4EB40-DNS-V1	08313040133	5	SJ1W-M5EB30-DPS	08313050112	6
SJ1W-G4EB40-DNÖ-V1	08313040143	5	SJ1W-M5EB30-DPÖ	08313050122	6
G5					
SJ1,5-G5EB25-DPS	08313050151	6	SJ1W-M5EB30-DNS	08313050132	6
SJ1,5-G5EB25-DPÖ	08313050152	6	SJ1W-M5EB30-DNÖ	08313050142	6
SJ1,5-G5EB25-DNS	08313050153	6	SJ1-M5EB40-DPS-V1	08313050111	6
SJ1,5-G5EB25-DNÖ	08313050154	6	SJ1-M5EB40-DPÖ-V1	08313050121	6
G6,5					
SJ1,5-G6,5EB18-DPS	08313650151	7	SJ1-M5EB40-DNS-V1	08313050131	6
SJ1,5-G6,5EB18-DPÖ	08313650152	7	SJ1-M5EB40-DNÖ-V1	08313050141	6
SJ1,5-G6,5EB18-DNS	08313650153	7	M8		
SJ1,5-G6,5EB18-DNÖ	08313650154	7	SJ1,5-M8EB18-DPS	08313080151	9
SJ2-G6,5EB18-DPS	08313650210	7	SJ1,5-M8EB18-DPÖ	08313080152	9
SJ2-G6,5EB18-DPÖ	08313650220	7	SJ1,5-M8EB18-DNS	08313080153	9
SJ2-G6,5EB18-DNS	08313650230	7	SJ1,5-M8EB18-DNÖ	08313080154	9
SJ2-G6,5EB18-DNÖ	08313650240	7	SJ2-M8EB18-DPS	08313080210	9
SJ3-G6,5EB18-DPS	08313650310	7	SJ2-M8EB18-DPÖ	08313080220	9
SJ3-G6,5EB18-DPÖ	08313650320	7	SJ2-M8EB18-DNS	08313080230	9
SJ3-G6,5EB18-DNS	08313650330	7	SJ2-M8EB18-DNÖ	08313080240	9
SJ3-G6,5EB18-DNÖ	08313650340	7	SJ3-M8EB18-DPS	08313080310	9
SJ1,5-G6,5EB18-DPS-W	08313650155	7	SJ3-M8EB18-DPÖ	08313080320	9
SJ1,5-G6,5EB18-DPÖ-W	08313650156	7	SJ3-M8EB18-DNS	08313080330	9
SJ1,5-G6,5EB18-DNS-W	08313650157	7	SJ3-M8EB18-DNÖ	08313080340	9
SJ1,5-G6,5EB18-DNÖ-W	08313650158	7	SJ1,5-M8EB32-DPS-V1	08313080155	10
SJ2-G6,5EB18-DPS-W	08313650212	8	SJ1,5-M8EB32-DPÖ-V1	08313080156	10
SJ2-G6,5EB18-DPÖ-W	08313650222	8	SJ1,5-M8EB32-DNS-V1	08313080157	10
SJ2-G6,5EB18-DNS-W	08313650232	8	SJ1,5-M8EB32-DNÖ-V1	08313080158	10
SJ2-G6,5EB18-DNÖ-W	08313650242	8	SJ2-M8EB32-DPS-V1	08313080211	10
SJ3-G6,5EB18-DPS-W	08313650312	8	SJ2-M8EB32-DPÖ-V1	08313080221	10
SJ3-G6,5EB18-DPÖ-W	08313650322	8	SJ2-M8EB32-DNS-V1	08313080231	10
SJ3-G6,5EB18-DNS-W	08313650332	8	SJ2-M8EB32-DNÖ-V1	08313080241	10
SJ3-G6,5EB18-DNÖ-W	08313650342	8	SJ3-M8EB32-DPS-V1	08313080311	10
SJ1,5-G6,5EB32-DPS-V1	08313651511	8	SJ3-M8EB32-DPÖ-V1	08313080321	10
SJ1,5-G6,5EB32-DPÖ-V1	08313651521	8	SJ3-M8EB32-DNS-V1	08313080331	10
SJ1,5-G6,5EB32-DNS-V1	08313651531	8	SJ3-M8EB32-DNÖ-V1	08313080341	10
SJ1,5-G6,5EB32-DNÖ-V1	08313651541	8	Q5		
SJ2-G6,5EB32-DPS-V1	08313651211	8	SJ1-Q5MB26-DPS	08313550110	6
SJ2-G6,5EB32-DPÖ-V1	08313651221	8	SJ1-Q5MB26-DPÖ	08313550120	6
SJ2-G6,5EB32-DNS-V1	08313651231	8	SJ1-Q5MB26-DNS	08313550130	6
SJ2-G6,5EB32-DNÖ-V1	08313651241	8	SJ1-Q5MB26-DNÖ	08313550140	6
SJ3-G6,5EB32-DPS-V1	08313651311	9	Q8		
SJ3-G6,5EB32-DPÖ-V1	08313651321	9	SJ1,5-Q8MB16-DPS	08313880151	12
SJ3-G6,5EB32-DNS-V1	08313651331	9	SJ1,5-Q8MB16-DPÖ	08313880152	12
SJ3-G6,5EB32-DNÖ-V1	08313651341	9	SJ1,5-Q8MB16-DNS	08313880153	12
G8					
SJ1,5-G8EB18-DPS	08313680151	10	SJ1,5-Q8MB16-DNÖ	08313880154	12
SJ1,5-G8EB18-DPÖ	08313680152	10	SJ2-Q8MB16-DPS	08313880210	12
SJ1,5-G8EB18-DNS	08313680153	10	SJ2-Q8MB16-DPÖ	08313880220	12
SJ1,5-G8EB18-DNÖ	08313680154	10	SJ2-Q8MB16-DNS	08313880230	12
SJ2-G8EB18-DPS	08313680210	11	SJ2-Q8MB16-DNÖ	08313880240	12
SJ2-G8EB18-DPÖ	08313680220	11	SJ3-Q8MB16-DPS	08313880310	12
SJ2-G8EB18-DNS	08313680230	11	SJ3-Q8MB16-DPÖ	08313880320	12
SJ2-G8EB18-DNÖ	08313680240	11	SJ3-Q8MB16-DNS	08313880330	12
SJ3-G8EB18-DPS	08313680310	11	SJ3-Q8MB16-DNÖ	08313880340	12
SJ3-G8EB18-DPÖ	08313680320	11	SJ1,5-Q8MB28-DPS-V1	08313880155	13
SJ3-G8EB18-DNS	08313680330	11	SJ1,5-Q8MB28-DPÖ-V1	08313880156	13
SJ3-G8EB18-DNÖ	08313680340	11	SJ1,5-Q8MB28-DNS-V1	08313880157	13
SJ1,5-G8EB32-DPS-V1	08313680155	11	SJ1,5-Q8MB28-DNÖ-V1	08313880158	13
SJ1,5-G8EB32-DPÖ-V1	08313680156	11	SJ2-Q8MB28-DPS-V1	08313880211	13
SJ1,5-G8EB32-DNS-V1	08313680157	11	SJ2-Q8MB28-DPÖ-V1	08313880221	13
SJ1,5-G8EB32-DNÖ-V1	08313680158	11	SJ2-Q8MB28-DNS-V1	08313880231	13
SJ2-G8EB32-DPS-V1	08313680211	11	SJ2-Q8MB28-DNÖ-V1	08313880241	13
SJ2-G8EB32-DPÖ-V1	08313680221	11	SJ3-Q8MB28-DPS-V1	08313880311	13
SJ2-G8EB32-DNS-V1	08313680231	11	SJ3-Q8MB28-DPÖ-V1	08313880371	13
SJ2-G8EB32-DNÖ-V1	08313680241	11	SJ3-Q8MB28-DNS-V1	08313880331	13
			SJ3-Q8MB28-DNÖ-V1	08313880381	13

Distribution office:

Postcode area:
16, 17, 18, 19, 20-29,
30, 31, 32, 38, 39, 49
Uwe Reisewitz
Waakhauserstraße 9
D-28719 Bremen
Phone: +49 4 21 / 64 26 44
Fax: +49 4 21 / 64 40 28 1
Mobile: +49 1 71 / 63 75 86 8

Postcode area:
40, 41, 42, 44, 45, 46, 47, 48,
50, 51, 52, 53, 54, 55, 56
Christoph Gilgenberg
Pascalstraße 22
D-53840 Troisdorf
Phone: +49 22 41 / 97 41 24
Fax: +49 22 41 / 97 30 63
Mobile: +49 1 71 / 63 75 86 6

Postcode area:
33-37, 57, 58, 59, 60,
61, 63, 64, 65, 68, 69
Konrad Wiegand
Am Heydewolf 6
D-35274 Kirchhain
Phone: +49 64 22 / 92 29 23
Fax: +49 64 22 / 92 29 24
Mobile: +49 1 71 / 63 75 86 3

Postcode area:
01-04, 08-10, 12, 13,
14, 15
Mark Braun
Neue Schichtstraße 14
D-09366 Niederdorf
Phone: +49 3 72 96 / 930 203
Fax: +49 3 72 96 / 930 187
Mobile: +49 1 71 / 637 58 57

Postcode area:
66, 67, 77, 78,
79, 721, 722
SKA Tec GmbH & Co. KG
Dieter Schley
Alemannenstraße 53
D-77767 Appenweiler
Phone.: +49 78 05 / 99 85 0
Fax: +49 78 05 / 91 02 55

Postcode area:
80, 81, 82, 83, 84, 85,
90, 91, 92, 93, 94
Adolf Hutner
Ascherbachweg 2a
D-85232 Neuhimmelreich
Phone: +49 81 31 / 35 08 73
Fax: +49 81 31 / 35 08 72
Mobile: +49 1 71 / 63 75 86 2

Postcode area:
92, 93, 95, 96, 97
C + R Automation GmbH
Christian Rott
Weinzierleiner Straße 9
D-90513 Zirndorf
Phone: +49 9 11 / 60 43 67
Fax: +49 9 11 / 600 24 09
Mobile: +49 1 70 / 798 72 39

Postcode area:
70, 71, 72, 73, 74, 75,
76, 86, 87, 88, 89
Andreas Barth
Vogelstraße 15
D-89269 Vöhringen
Phone: +49 73 06 / 92 40 82
Fax: +49 73 06 / 92 24 61
Mobile: +49 1 71 / 63 75 85 6

Postcode area:
06, 07, 98, 99
Riese Electronic GmbH
Thomas Schüler
Schleizerstraße 36 - 38
D-07937 Zeulenroda
Phone: +49 3 66 28 / 725 11
Fax: +49 3 66 28 / 725 17
Mobile: +49 1 72 / 367 13 62



p·u·l·s·o·t·r·o·n·i·c

Pulsotronic GmbH & Co. KG

Neue Schichtstraße 14

D-09366 Niederdorf

Phone +49 37 296 / 930 100

Telefax +49 37 296 / 930 180

info@pulsotronic.de

www.pulsotronic.de